

Electronic Box

Plastic Bolt Type for Opening/Closing – IP67



► We have developed a small electronic box that can be used for various purposes such as electronic, communication, control panel, etc.

► It is strong and has a good exterior. In addition, it is easy to work and has an excellent water-resistance and dust-resistance.

► It is convenient for the usages such as terminal box, small terminal, measuring equipment box, terminal, control box, signal device, communication connection box, etc.

Materials & Composition Table

A G	•Material:ABS •Color: Gray	A T	•Material:Cover(PC), Body(ABS) •Color: Cover(Clear), Body(Gray)
P G	•Material:AC Flammability •Color: Gray	P T	•Material:Cover(PC), Body(AC) •Color: Cover(Clear), Body(Gray)
P C G	•Material:POLYESTER •Color: Gray	P C T	•Material:Cover(PC), Body(POLYESTER) •Color: Cover(Clear), Body(Gray)

ABS:Acrylonitrile Butadiene Styrene	P C:PolyCarbonate
Polyester : PBT+PC	AC:ABS(30%)+PC(70%)

► **DIE CAST BOX** Product has 6 product names as shown above and can be made of any of 4 materials shown above. DIE CAST BOX Product acquired IP67 Grade on each product manufactured by any of 4 materials.

Part Number	Dimensions(mm)			Inch	Others
	W	H	D		
EL-000-1308	80	130	35	3.15 × 5.12 × 1.38	
EL-000-1313	130	130	35	5.12 × 5.12 × 1.38	
EL-000-1318	130	180	35	5.12 × 7.09 × 1.38	
EL-000-1308-B	80	130	60	3.15 × 5.12 × 2.36	
EL-000-1313-B	130	130	60	5.12 × 5.12 × 2.36	
EL-000-1318-B	130	180	60	5.12 × 7.09 × 2.36	

- 000 mark of product at the above product list is to express a material.
- Materials : AG, AT, PG, PT, PCG, PCT
- Please refer to Material Composition Diagram by Products on Page 13.

Model \ Division	H1	H2	H3	H4	W1	W2	W3	W4	D1	D2
EL-1308	132	126	113	95	82	76	63	45	25	10
EL-1313	130	124	113	95	130	124	113	95	25	10
EL-1318	180	172	163	146	130	122	113	96	25	10
EL-1308-B	132	126	113	95	82	76	63	45	50	10
EL-1313-B	130	124	113	95	130	124	113	95	50	10
EL-1318-B	180	172	163	146	130	122	113	96	50	10

Dimension (Allowable error: ± 1mm)

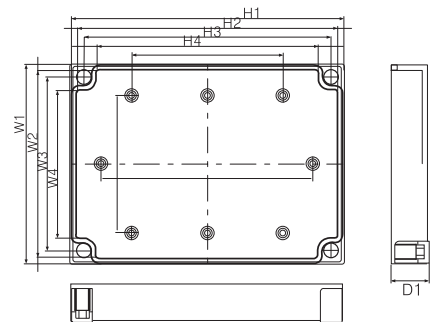

BODY

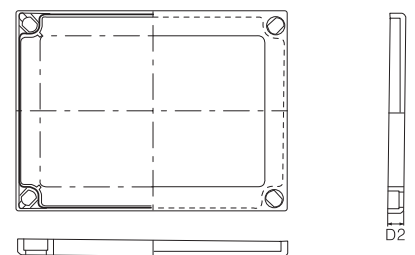

COVER

Accessories

Model	SUS Bracket	Plastic Bracket
EL-000-1308	DS-B-40	DS-PB-30/40
EL-000-1313	DS-B-40	DS-PB-30
EL-000-1318	DS-B-40	DS-PB-30
EL-000-1308-B	DS-B-40	DS-PB-30/40
EL-000-1313-B	DS-B-40	DS-PB-30
EL-000-1318-B	DS-B-40	DS-PB-30



DS-B-40

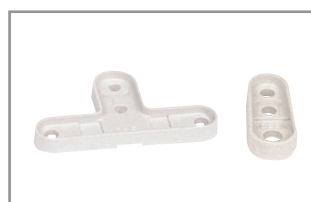

DS-PB-40/30